

vtech[®]

Parent's Guide

**Go! Go!
Smart Friends**[®]

Shimmering Seashell Castle[™]



91-003390-002 US

INTRODUCTION

Thank you for purchasing the **VTech® Go! Go! Smart Friends® Shimmering Seashell Castle™!** Watch Pearl the mermaid come to life when you place her on the three **MagicPoint®** locations as you explore the wonders under the sea.

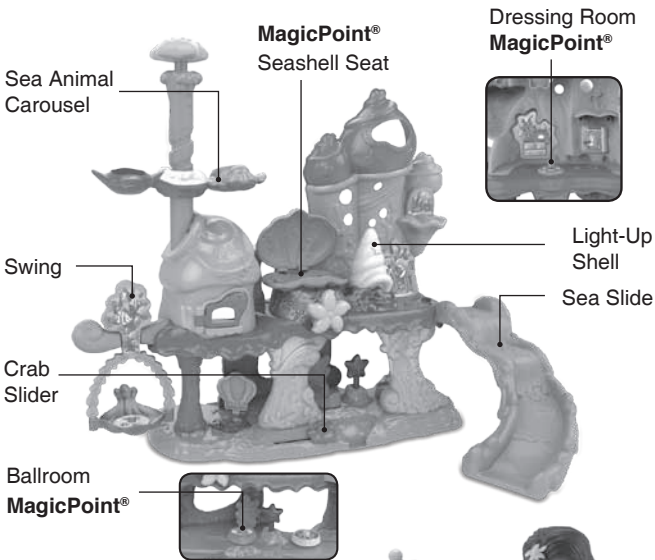

Sea Horse



Dolphin



Vanity



Sand Castle



MagicPoint®
Character

INCLUDED IN THIS PACKAGE

NOTE: This toy is not intended for teething.
This toy is not intended for play in water.



- One **MagicPoint**[®] character - Pearl



- One seashell seat with **MagicPoint**[®]



- One small castle cove



- One castle roof



- One castle wall

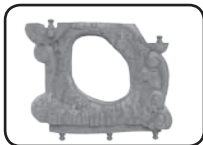

- One back wall



- Two pillars



- One transparent wall (A)



- One transparent wall (B)



- One 2nd floor base with dressing room **MagicPoint®**



- One 1st floor base with ballroom **MagicPoint®**



- One double pillar

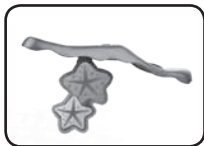

- One starfish chandelier



- One swing



- One sea slide



- One sea weed



- One star

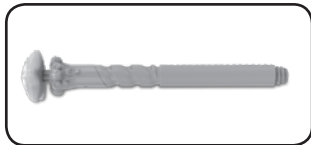

- One carousel pillar



- One carousel animals

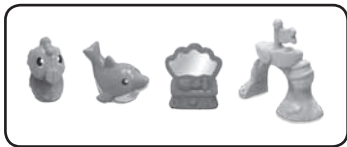

- Accessories

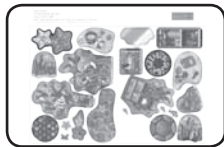

- One label sheet

Unlock the packaging lock:

There is one packaging lock located on the character.

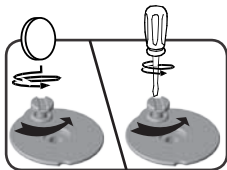

- ① Use a coin or screwdriver to loosen the screw.
- ② Pull out the screw with the packaging lock and discard them.

Unlock the packaging lock:

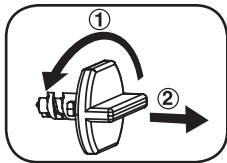

- ① Turn the packaging lock counterclockwise several times.
- ② Pull out and discard the packaging lock.

WARNING:

All packing materials such as tape, plastic sheets, packaging locks, removable tags, cable ties and packaging screws are not part of this toy, and should be discarded for your child's safety.

NOTE: Please keep this parent's guide as it contains important information.

ATTENTION

Pour la sécurité de votre enfant, débarrassez-vous de tous les produits d'emballage tels que rubans adhésifs, feuilles de plastique, attaches, étiquettes et vis d'emballage. Ils ne font pas partie du jouet.

NOTE: Il est conseillé de conserver ce guide des parents car il comporte des informations importantes.

GETTING STARTED

Battery Installation - Character

1. Make sure the unit is **OFF**.
2. Locate the battery cover on the bottom of the unit. Use a screwdriver to loosen the screws.
3. Install 2 new AAA (AM-4/LR03) batteries following the diagram inside the battery box. (The use of new alkaline batteries is recommended for maximum performance.)
4. Replace the battery cover and tighten the screws to secure.

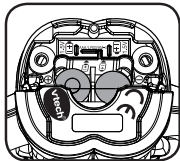
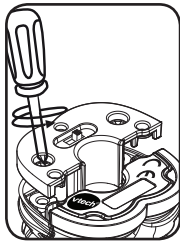

BATTERY NOTICE

- Use new alkaline batteries for best performance.
- Use only batteries of the same or equivalent type as recommended.
- Do not mix different types of batteries: alkaline, standard (carbonzinc) or rechargeable (Ni-Cd, Ni-MH), or new and used batteries.
- Do not use damaged batteries.
- Insert batteries with the correct polarity.
- Do not short-circuit the battery terminals.

- Remove exhausted batteries from the toy.
- Remove batteries during long periods of non-use.
- Do not dispose of batteries in fire.
- Do not charge non-rechargeable batteries.
- Remove rechargeable batteries from the toy before charging (if removable).
- Rechargeable batteries are only to be charged under adult supervision.

CAUTION:

Adult assembly required. For your child's safety, do not let your child play with the toy until it is fully assembled.

ASSEMBLY INSTRUCTIONS

With the VTech® Go! Go! Smart Friends® Shimmering Seashell Castle™ safety comes first. To ensure your child's safety, adult assembly is required.

1. Insert the **Sea Weed** into the **1st Floor Base** as shown in the picture.

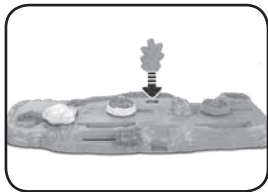

2. Insert the two **Pillars** into the **1st Floor Base** as shown in the picture.

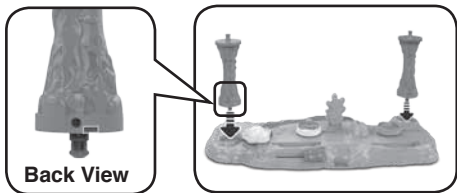

3. Insert the **Star** into the **1st Floor Base** as shown in the picture.

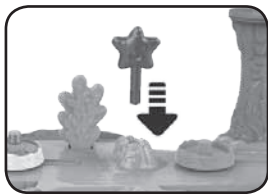

4. Insert the **Back Wall** into the **1st Floor Base** as shown in the picture.

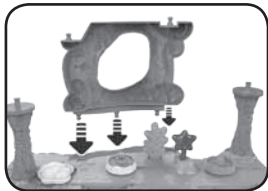

5. Insert **Transparent Wall (A)** and **Transparent Wall (B)** into the **1st Floor Base** as shown in the picture.

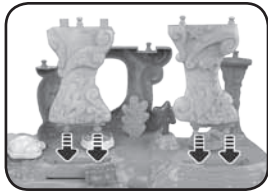

6. Insert the **2nd Floor Base** into the two **Pillars**, **Back Wall**, **Transparent Wall (A)** and **Transparent Wall (B)** as shown in the picture.

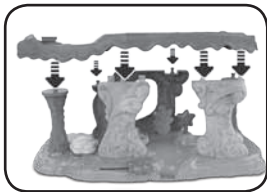

7. Insert the **Castle Roof** into the **Castle Wall** to create the big castle.

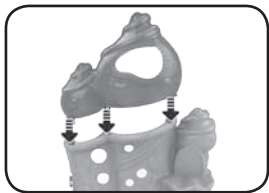

8. Insert the big castle into the **2nd Floor Base** as shown in the picture.

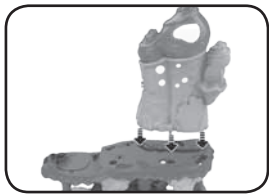

9. Insert the **Small Castle Cove** into the **2nd Floor Base** as shown in the picture.

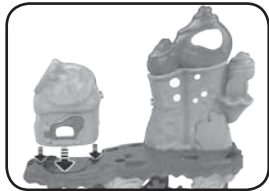

10. Attach the **Small Castle Cove** to the **big castle** with the **Double Pillar** as shown in the picture.

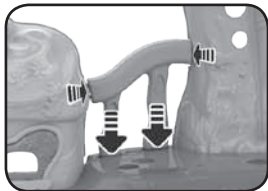

11. Attach the **Carousel Pillar** to the **Carousel Animals** as shown in the picture.

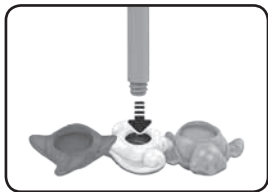

12. Insert the **Carousel Pillar** through the Small Castle Cove and into the **2nd Floor Base** as shown in the picture.

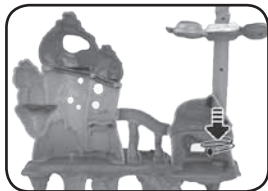

13. Insert the **Starfish Chandelier** into the big castle as shown in the picture.

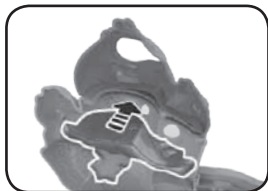

14. Rotate the **Swing** and attach it to the **2nd Floor Base** as shown in the picture.

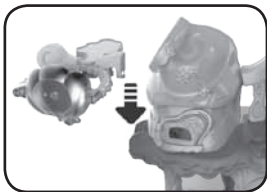
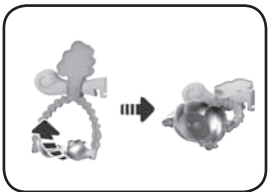

15. Attach the **Sea Slide** to the **2nd Floor Base** as shown in the picture.

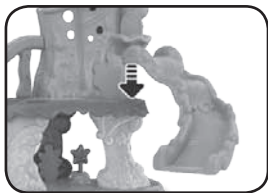

16. Insert the **Seashell Seat** to the **2nd Floor Base** as shown in the picture.

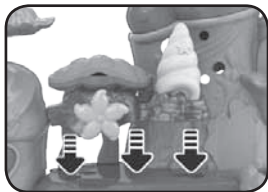

LABEL APPLICATION

Please securely adhere the labels to the playset as indicated below.

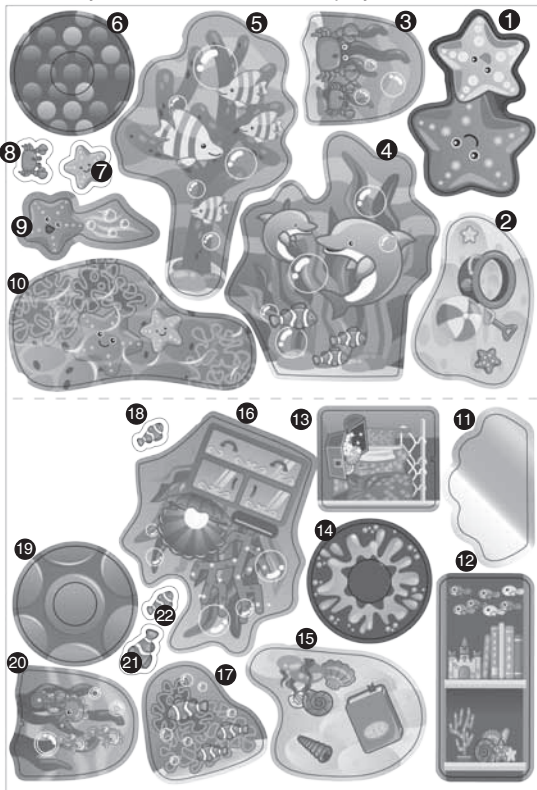

Position:

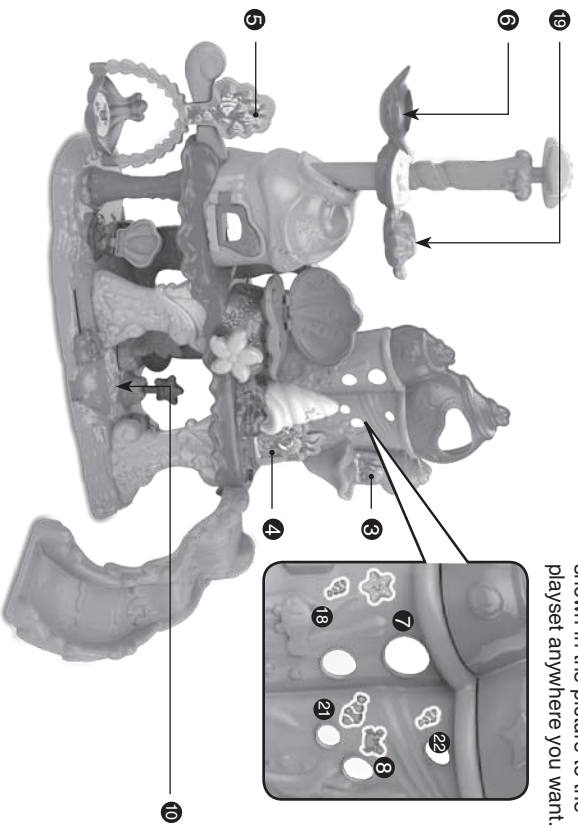

Please adhere the labels shown in the picture to the playset anywhere you want.

Position:

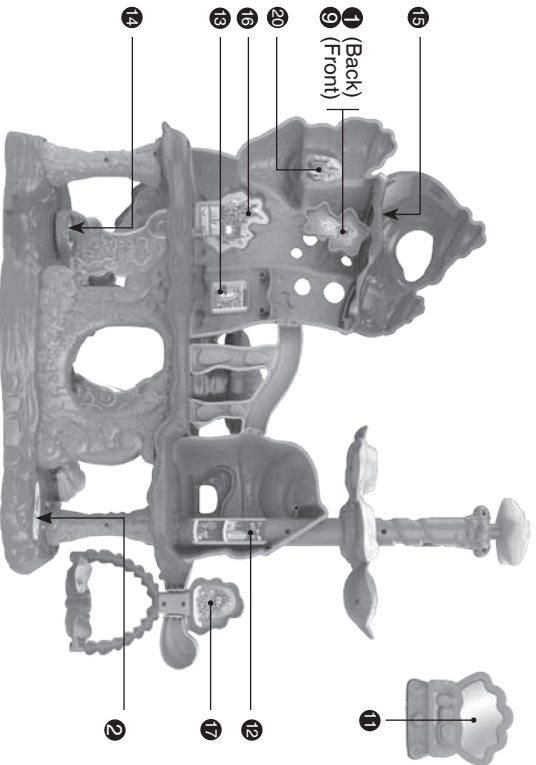

PRODUCT FEATURES

1. On/Off Switch

The **On/Off Switch** is located on the bottom of the character.

To turn the unit **On**, slide the **On/Off Switch** to the **On** (⏻) position. To turn the unit **Off**, slide the **On/Off Switch** to the **Off** (●) position.

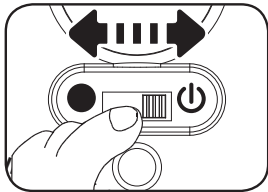

2. Automatic Shut Off

To preserve battery life, the **VTech® Go! Go! Smart Friends® Character** will automatically power down after several minutes without input. The unit can only be turned on again by pressing the **Light-Up Button** or placing it on a **MagicPoint®** location.

The **Light-Up Button** will flash several times and power down when the unit's battery level is low. If this happens, we suggest replacing the batteries with new ones.

ACTIVITIES – CHARACTER

1. Light-Up Button

Press the **Light-Up Button** to hear phrases, songs, melodies and fun sounds.



2. **MagicPoint® Locations**

Place the **MagicPoint® Character** on the playset's three **MagicPoint®** locations to hear phrases, fun sounds, short tunes and sing-along songs. The character can also interact with other **VTech® Go! Go! Smart Friends®** playsets (each sold separately).

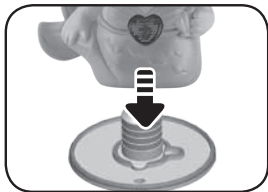

ACTIVITIES – SHIMMERING SEASHELL CASTLE™

1. **Seashell Seat**

Place the **MagicPoint® Character** on the **Seashell Seat MagicPoint®** location to hear fun sounds, short tunes, songs and watch the **Light-Up Shell** change colors.



2. **Dressing Room**

Place the **MagicPoint® Character** on the **Dressing Room MagicPoint®** location to hear fun sounds.



3. **Ballroom**

Place the **MagicPoint® Character** on the **Ballroom MagicPoint®** location for fun sounds and songs.



4. **Seashell**

Turn the **Flower** to open and close the **MagicPoint® Seashell Seat**.

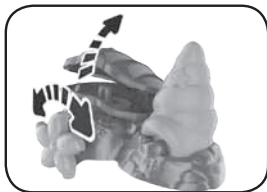

5. **Sea Animal Carousel**

Place the **MagicPoint® Character** on the **Sea Animal Carousel** and press the button to spin them down.



6. **Crab Slider**

Place the **MagicPoint® Character** and a friend on the **Ballroom MagicPoint®**. Slide the **Crab Slider** to see the characters twirl.



7. **Swing**

Push the **MagicPoint® Character** on the **Swing**.



8. **Slide**

Push the **MagicPoint® Character** down the **Slide**.

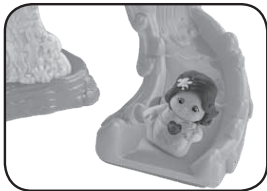

SONGS

1. Nice to meet you, my name's Pearl,
I love exploring my underwater world!
2. It's fun to splash around in the sea,
Come along and swim with me!
3. With a bit of magic and a whole lot of fun,
Let's have an adventure with everyone.

MELODY LIST

1. Beautiful Dreamer
2. Git Along Little Dogies
3. Hey Diddle Diddle
4. Listen to the Mockingbird
5. Sailing, Sailing
6. This Old Man

CARE & MAINTENANCE

1. Keep the unit and its metal parts clean by wiping them with a slightly damp cloth.
2. Keep the unit out of direct sunlight and away from any direct heat sources.
3. Remove the batteries when the unit is not in use for an extended period of time.
4. Do not drop the unit on a hard surface and do not expose the unit to excess moisture or water.

TROUBLESHOOTING

If for some reason the unit stops working or malfunctions while playing with the **MagicPoint**[®] accessory, please remove the character from the accessory and place the character back onto the **MagicPoint**[®] location. If the unit still does not function, or if for some reason the unit stops working or malfunctions on its own, please follow these steps:

1. Please turn the unit **OFF**.
2. Interrupt the power supply by removing the batteries.
3. Let the unit stand for a few minutes, then replace the batteries.
4. Turn the unit **ON**. The unit should now be ready to play again.
5. If the product still does not work, replace with a new set of batteries.

If the problem persists, please call our Consumer Services Department at 1-800-521-2010 in the U.S. or 1-877-352-8697 in Canada, or by going to our website at vtechkids.com and filling out our Contact Us form located under the Customer Support link. A service representative will be happy to help you.

IMPORTANT NOTE:

Creating and developing **VTech**[®] Toddler Learning products is accompanied by a responsibility that we at **VTech**[®] take very seriously. We make every effort to ensure the accuracy of the information which forms the value of our products. However, errors sometimes can occur. It is important for you to know that we stand behind our products and encourage you to call our Consumer Services Department at 1-800-521-2010 in the U.S. or 1-877-352-8697 in Canada, or by going to our website at vtechkids.com and filling out our Contact Us form located under the Customer Support link with any problems and/or suggestions that you might have. A service representative will be happy to help you.

Note: This equipment has been tested and found to comply with the limits for a Class B digital device, pursuant to Part 15 of the FCC Rules. These limits are designed to provide reasonable protection against harmful interference in a residential installation. This equipment generates, uses and can radiate radio frequency energy and, if not installed and used in accordance with the instructions, may cause harmful interference to radio communications. However, there is no guarantee that interference will not occur in a particular installation. If this equipment does cause harmful interference to radio or television reception, which can be determined by turning the equipment off and on, the user is encouraged to try to correct the interference by one or more of the following measures:

- Reorient or relocate the receiving antenna.
- Increase the separation between the equipment and receiver.
- Connect the equipment into an outlet on a circuit different from that to which the receiver is connected.
- Consult the dealer or an experienced radio/TV technician for help.

Caution: Changes or modifications not expressly approved by the party responsible for compliance could void the user's authority to operate the equipment.

THIS DEVICE COMPLIES WITH PART 15 OF THE FCC RULES. OPERATION IS SUBJECT TO THE FOLLOWING TWO CONDITIONS:

(1) THIS DEVICE MAY NOT CAUSE HARMFUL INTERFERENCE, AND (2) THIS DEVICE MUST ACCEPT ANY INTERFERENCE RECEIVED, INCLUDING INTERFERENCE THAT MAY CAUSE UNDESIRE OPERATION.

CAN ICES-3 (B)/NMB-3(B)

**CLASS 1
LED PRODUCT**



PRODUCT WARRANTY

This Warranty is applicable only to the original purchaser, is non-transferable and applies only to "VTECH" products or parts. This product is covered by a 3-month Warranty from the original purchase date, under normal use and service, against defective workmanship and materials. This Warranty does not apply to (a) consumable parts, such as batteries; (b) cosmetic damage, including but not limited to scratches and dents; (c) damage caused by use with non-VTECH products; (d) damage caused by accident, misuse, unreasonable use, immersion in water, neglect, abuse, battery leakage, or improper installation, improper service, or other external causes; (e) damage caused by operating the product outside the permitted or intended uses described by VTECH in the owner's manual; (f) a product or part that has been modified (g) defects caused by normal wear and tear or otherwise due to the normal aging of the product; or (h) if any VTECH serial number has been removed or defaced.

Prior to returning a product for any reason, please notify the VTECH Consumer Services Department by going to our website at vtechkids.com, filling out our Contact Us form located under the Customer Support link or calling 1-800-521-2010.

If the service representative is unable to resolve the issue, you will be provided instructions on how to return the product and have it replaced under Warranty. Return of the product under Warranty must adhere to the following rules: If VTECH believes that there may be a defect in the materials or workmanship of the product and can confirm the purchase date and location of the product, we will at our discretion replace the product with a new unit or product of comparable value. A replacement product or parts assumes the remaining Warranty of the original product or 30 days from the date of replacement, whichever provides longer coverage.

THIS WARRANTY AND THE REMEDIES SET FORTH ABOVE ARE EXCLUSIVE AND IN LIEU OF ALL OTHER WARRANTIES, REMEDIES AND CONDITIONS, WHETHER ORAL, WRITTEN, STATUTORY, EXPRESS OR IMPLIED. IF VTECH CANNOT LAWFULLY DISCLAIM STATUTORY OR IMPLIED WARRANTIES THEN TO THE EXTENT PERMITTED BY LAW, ALL SUCH WARRANTIES SHALL BE LIMITED TO THE DURATION OF THE EXPRESS WARRANTY AND TO THE REPLACEMENT SERVICE AS DETERMINED BY VTECH IN ITS SOLE DISCRETION.

To the extent permitted by law, VTECH will not be responsible for direct, special, incidental or consequential damages resulting from any breach of Warranty.

This Warranty is not intended to persons or entities outside the United States of America. Any disputes resulting from this Warranty shall be subject to the final and conclusive determination of VTECH.

**Visit our website for more
information about our products,
downloads, resources and more.**

vtechkids.com

